

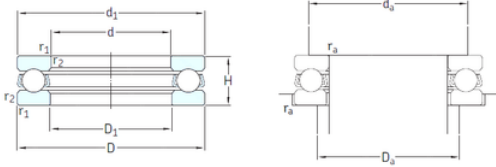

China 6205 2rs Bearing Supplier



SKF Bearing 51116 51117 51118 51120 51122
51124 51126 51128 51130m 51132m

Bearing No. 51116

51116 Bearing 2D drawings and 3D CAD models

| | |
|-------------------------------|---------------------|
| Size | 80x105x19 mm |
| Bore Diameter | 80 mm |
| Outer Diameter | 105 mm |
| Width | 19 mm |
| d | 80 mm |
| D | 105 mm |
| H | 19 mm |
| d1 | 105 mm |
| r1 min. | 1 mm |
| r2 min. | 1 mm |
| D1 | 82 mm |
| da min. | 95 mm |
| Da max. | 90 mm |
| ra max. | 1 mm |
| Weight | 0,42 Kg |
| Basic dynamic load rating (C) | 44,9 kN |
| Basic static load rating (C0) | 140 kN |
| Fatigue load limit (Pu) | 5,1 |
| Reference speed | 3000 r/min |
| Limiting speed | 4300 r/min |
| Category | Thrust Ball Bearing |
| Inventory | 0.0 |
| Manufacturer Name | SKF |
| Minimum Buy Quantity | N/A |
| Weight / Kilogram | 0.43 |



China 6205 2rs Bearing Supplier

| | |
|-------------------------------------|--|
| EAN | 7316576677687 |
| Product Group | B00308 |
| Rolling Element | Ball Bearing |
| Thrust Bearing | Yes |
| Single or Double Direction | Single Direction |
| Banded | No |
| Cage Material | Steel |
| Precision Class | ABEC 1 ISO P0 |
| Component Description | Roller Assembly Plus Raceways |
| Other Features | Single Row |
| Long Description | 80MM Bore 1; 82MM Bore 2; 105MM Outside Diameter; 19MM Height; Ball Bearing; Single Direction; Not Banded; Steel Cage; ABEC 1 ISO P0 Precision |
| Inch - Metric | Metric |
| Category | Thrust Ball Bearings |
| UNSPSC | 31171507 |
| Harmonized Tariff Code | 8482.10.50.08 |
| Noun | Bearing |
| Keyword String | Ball Thrust |
| Manufacturer URL | http://www.skf.com |
| Manufacturer Item Number | 51116 |
| Weight / LBS | 0.948 |
| Overall Height with Aligning Washer | 0 Inch 0 Millimeter |
| Bore 2 | 3.228 Inch 82 Millimeter |
| Outside Diameter | 4.134 Inch 105 Millimeter |
| Height | 0.748 Inch 19 Millimeter |
| Bore 1 | 3.15 Inch 80 Millimeter |
| bore diameter: | 80 mm |
| static load capacity: | 140 kN |



China 6205 2rs Bearing Supplier

| | |
|---|---------------------------|
| outside diameter: | 105 mm |
| dynamic load capacity: | 44.9 kN |
| overall width: | 19 mm |
| maximum rpm: | 4300 RPM |
| thrust bearing type: | Single-Direction |
| cage material: | Steel |
| outside diameter design: | Straight |
| fillet radius: | 1 mm |
| separable or banded: | Separable |
| series: | 511 |
| precision rating: | ABEC 1 (ISO Class Normal) |
| d_1 | 105 mm |
| D_1 | 82 mm |
| $r_{1,2}$ min. | 1 mm |
| d_a min. | 95 mm |
| D_a max. | 90 mm |
| r_a max. | 1 mm |
| Basic dynamic load rating C | 44.9 kN |
| Basic static load rating C_0 | 140 kN |
| Fatigue load limit P_u | 5.1 kN |
| Minimum load factor A | 0.12 |
| Mass bearing (including seat washer where applicable) | 0.42 kg |